

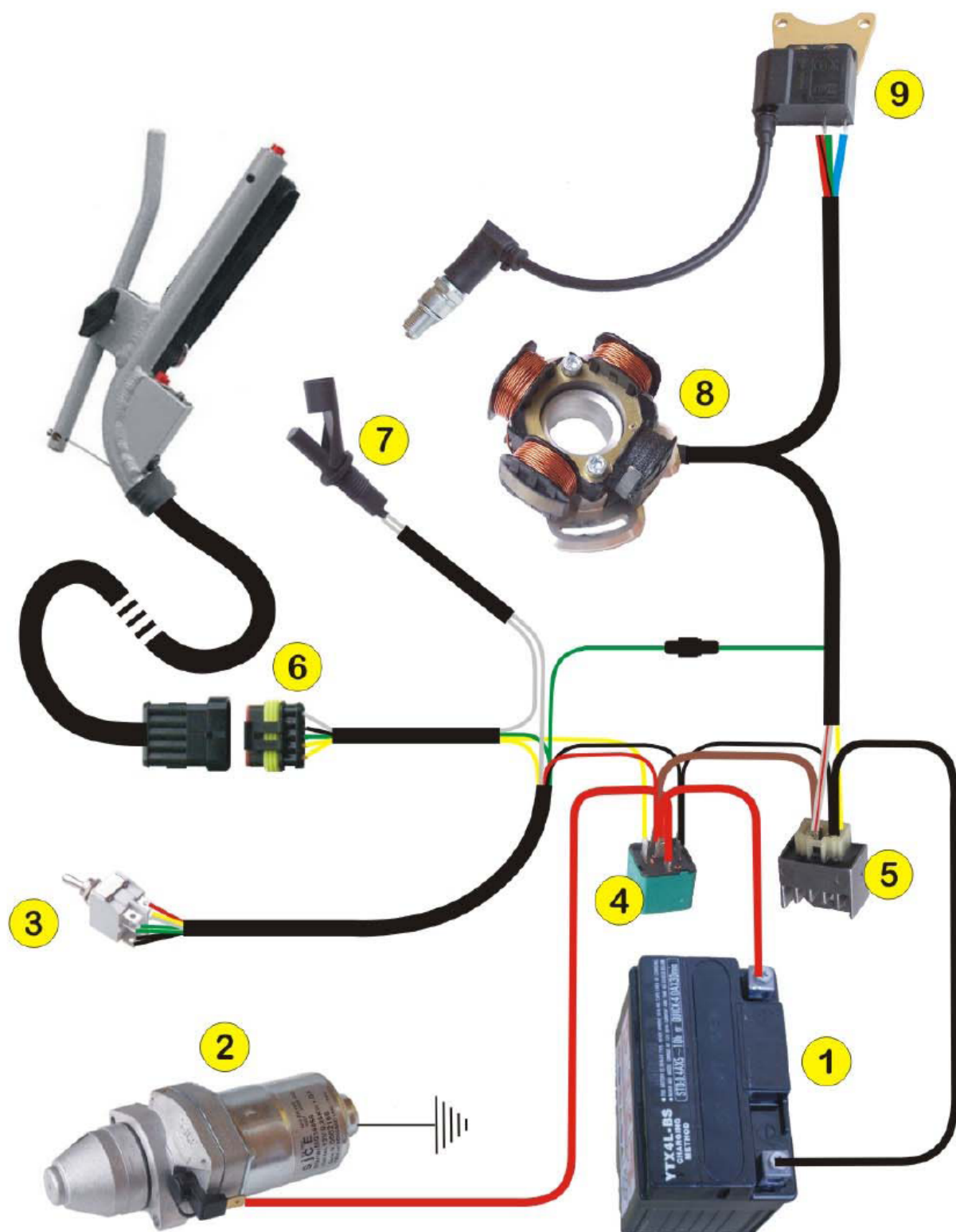







# Impianto elettrico

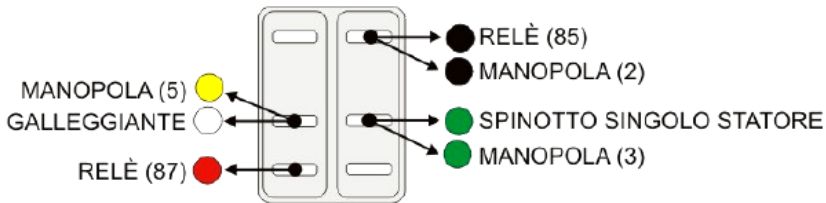

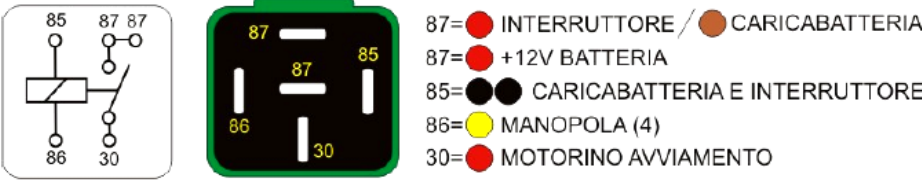
## Legenda dei componenti raffigurati nello schema:

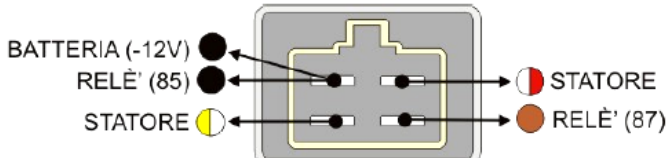
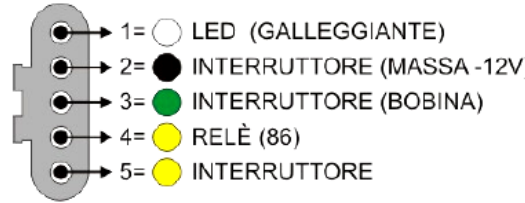
<b>1</b> - Batteria elettrica 12V.	
<b>2</b> - Motorino di avviamento	
<b>3</b> - Interruttore 	
<b>4</b> - Relè 	
<b>5</b> - Caricabatteria 	
<b>6</b> - Conn. Manopola 	
<b>7</b> - Galleggiante per spia basso livello carburante	
<b>8</b> - Statore	
<b>9</b> - Bobina 